

NOTES

- BATHYMETRY DATA IS FROM DMS PERFORMED BY FUGRO.
- TOPOGRAPHICAL DATA IS FROM "TOPOGRAPHICAL SURVEY OTRANTO LANDFALL", PERFORMED BY GAS. SURVEY ALIGNMENT CHARTS, REVISION 0 - 18/12/2010
- ELEVATIONS ARE IN METERS, RELATIVE TO LOWER ASTRONOMICAL TIDE (LAT).
- DETAILED SOIL AND BOREHOLE DATA PRESENTED IN WE9 SURVEY DATA REPORT DOC. NO. J35002-SDR9-C(3), DRAWING NO. J35002-RES9-C(3) BOOK C: LANDFALL / NEARSHORE CHARTS & SPECIAL SURVEY CHARTS

LEGEND

- Onshore Pipeline Route
 - - - HDD Trajectory
 - ~ Submarine Cable
 - · - · - Terna Power Cable (Onshore)
- UNIT 1 - P-Wave velocity up to 800 m/s, Loose overburden / made ground
 - UNIT 2 - P-Wave velocity 800 m/s, to 2500 m/s, Weathered Calcarenite
 - UNIT 3 - P-Wave velocity 2500+ m/s, Relatively competent calcarenite
 - UNIT 4 - SAND
 - POSIDONIA SEA GRASS
- ABBREVIATIONS**
- OLF = Otranto Landfall
 - FOC = Fibre Optic Cable
 - LAT = Lower Astronomical Tide

REFERENCE DRAWINGS

DRAWING NUMBER	DESCRIPTION
IGI-1314-30-PL-DWG-002-001	SHORE APPROACH PROFILE - ITALY, HDD DRILLING PROFILE
IGI-1314-30-PL-DWG-002-003	SHORE APPROACH PROFILE - ITALY, HDD ENTRY PIT
IGI-1314-30-PL-DWG-002-004	SHORE APPROACH PROFILE - ITALY, HDD EXIT PIT

SCALE BAR

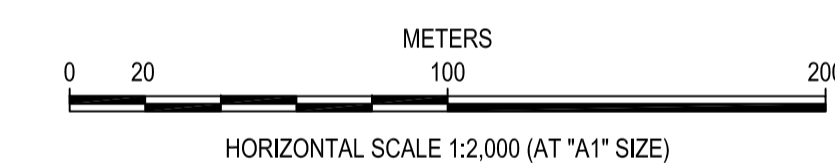

GEODETTIC & PROJECTION PARAMETERS

DATUM NAME	: World Geodetic System 1984
REFERENCE SPHEROID	: WGS84
Semi-major axis	: 6 378 137.000 m
Inverse flattening	: 298.257 223 563
PROJECTION	
Projection System	: Universal Transverse Mercator (UTM)
Unit of coordinates	: Meters
Latitude of origin	: 0° (Equator)
Central meridian (CM)	: 21° E (Zone 34 North)
False Easting at origin	: 500 000 m
False Northing at origin	: 0 m
Scale factor at CM	: 0.9996

Y1	14 MAR 2019	APPROVED FOR USE	SM	WHH	WHH	MVV	
Y0	22 FEB 2019	ISSUED FOR CLIENT REVIEW	SM	WHH	WHH	MVV	
YA	04 FEB 2019	ISSUED FOR INTERNAL REVIEW	SM	JB	JB		
REV	DATE	DESCRIPTION	DRWN	DSGN	ENGR	APPR	CLIENT

 WorleyParsons Group	PROJECT:	IGI Poseidon Offshore Section Update	
	CLIENT:	Project No.:	406010-00159
IGI Poseidon	WBS Code:	1314 (FEED Deliverables)	
	EDISON Doc. No.:		
	DEPA Doc. No.:		

**SHORE APPROACH PROFILE - ITALY
HDD DRILLING PROFILE WITH SOIL DATA**

DRAWN BY:	DATE:	CHECKED BY:	DATE:	APPROVED BY:	DATE:	SHEET:	002	OF	004
SM	22 JAN 2019	WHH	14 MAR 2019	MVV	14 MAR 2019				
SCALE AT 'A1' SIZE	PROJECT	CTR	AREA	DISCIPLINE	TYPE	NUMBER	REVISION		
1:2,000	IGI	1314	30	PL	DWG	002	Y1		

PLAN VIEW

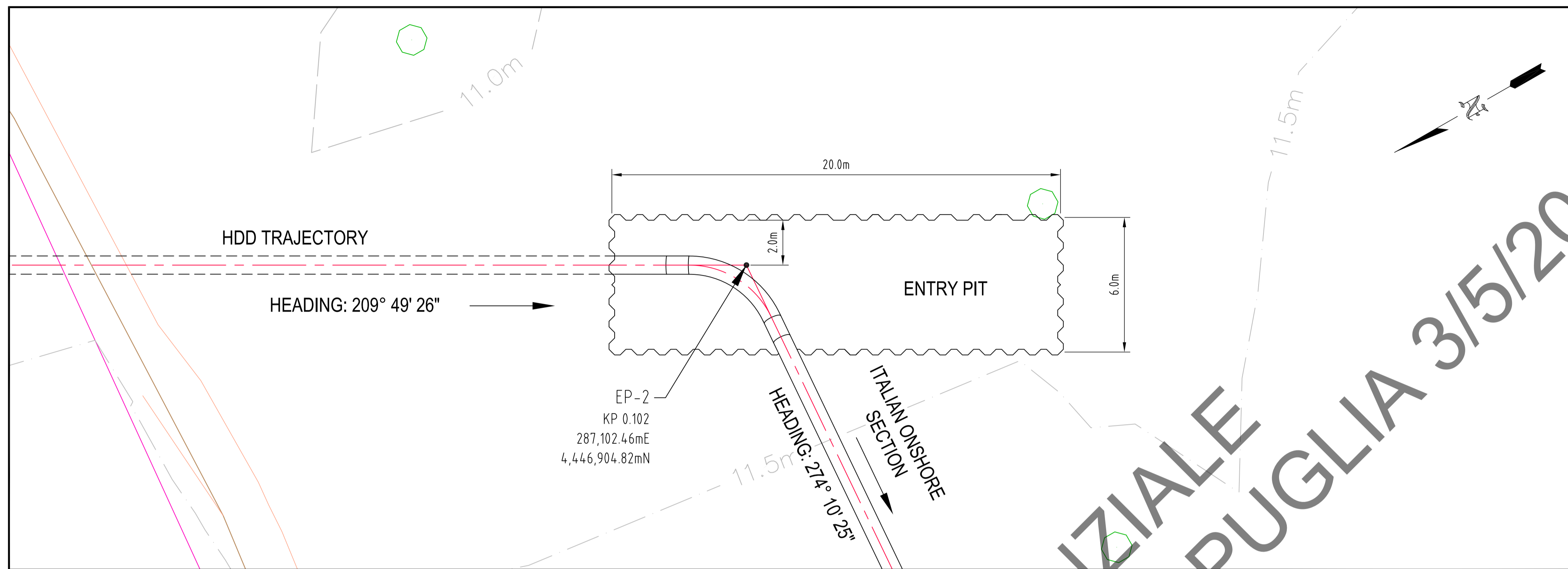

ELEVATION VIEW

EP-2

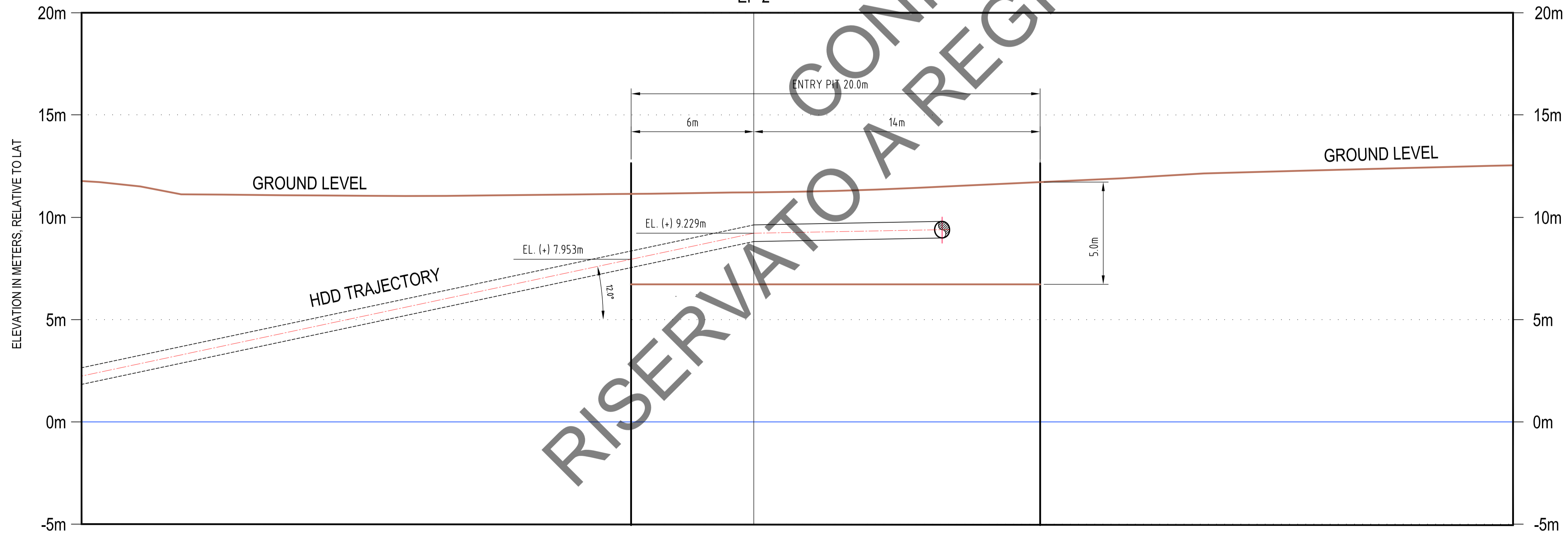

NOTES

1. DIMENSIONS ARE IN METERS, UNLESS NOTED OTHERWISE.
2. BATHYMETRY DATA IS FROM DMS PERFORMED BY FUGRO.
3. ELEVATIONS ARE IN METERS, RELATIVE TO LAT.

LEGEND

- Pipeline Route
- - - HDD Trajectory
- ~ Sheet Piles

ABBREVIATIONS

LAT = Lower Astronomical Tide

REFERENCE DRAWINGS

DRAWING NUMBER	DESCRIPTION
IGI-1314-30-PL-DWG-002-001	SHORE APPROACH PROFILE - ITALY, HDD DRILLING PROFILE
IGI-1314-30-PL-DWG-002-002	SHORE APPROACH PROFILE - ITALY, HDD DRILLING WITH SOIL DATA
IGI-1314-30-PL-DWG-002-004	SHORE APPROACH PROFILE - ITALY, HDD EXIT PIT

REV	DATE	DESCRIPTION	DRWN	DSGN	ENGR	APPR	CLIENT
Y1	14 MAR 2019	APPROVED FOR USE	SM	WHH	WHH	MVV	
Y0	22 FEB 2019	ISSUED FOR CLIENT REVIEW	SM	WHH	WHH	MVV	
YA	04 FEB 2019	ISSUED FOR INTERNAL REVIEW	SM	JB	JB		

 WorleyParsons Group	PROJECT: IGI Poseidon Offshore Section Update
	CLIENT: IGI Poseidon
	Project No.: 406010-00159 WBS Code: 1314 (FEED Deliverables) EDISON Doc. No.: DEPA Doc. No.:

TITLE:							
SHORE APPROACH PROFILE - ITALY							
HDD ENTRY PIT							

DRAWN BY:	DATE:	CHECKED BY:	DATE:	APPROVED BY:	DATE:	SHEET:	OF
SM	22 JAN 2019	WHH	14 MAR 2019	MVV	14 MAR 2019	003	004

SCALE AT 'A'1' SIZE	PROJECT	CTR	AREA	DISCIPLINE	TYPE	NUMBER	REVISION
1:125	IGI	1314	30	PL	DWG	002	Y1

PLAN VIEW

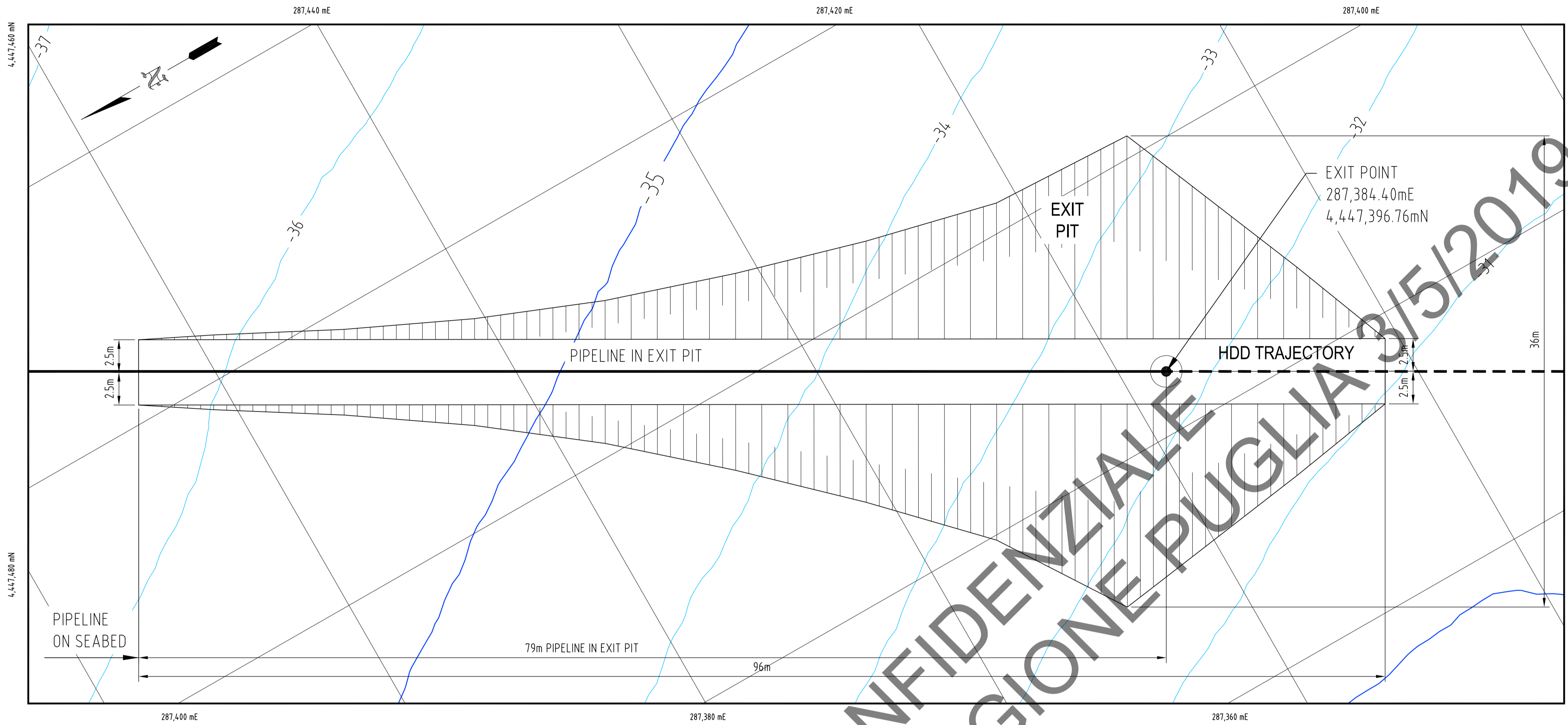

ELEVATION VIEW

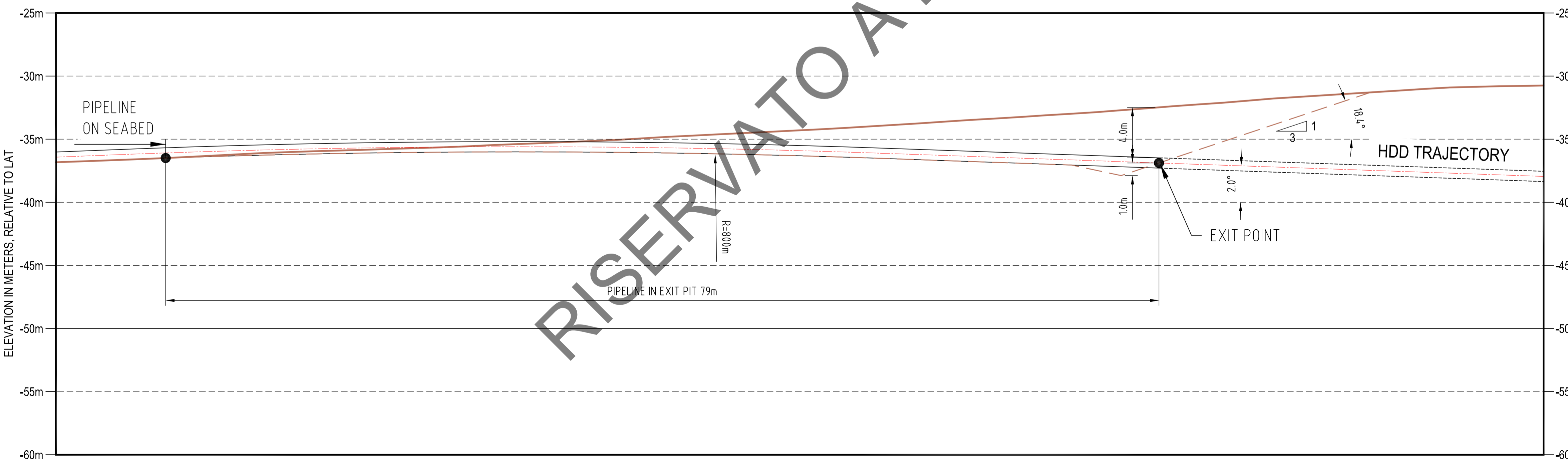

NOTES

1. DIMENSIONS ARE IN METERS, UNLESS NOTED OTHERWISE.
2. BATHYMETRY DATA IS FROM DMS PERFORMED BY FUGRO.
3. ELEVATIONS ARE IN METERS, RELATIVE TO LAT.
4. TRENCH SIDE SLOPE ANGLES 18.4° (1:3).
5. ESTIMATED EXIT PIT EXCAVATION VOLUME 2400m³.
6. ESTIMATED EXIT PIT FOOTPRINT 1550m².
7. ACTUAL DESIGN OF SEABED INTERVENTION WORKS SHALL BE PERFORMED BY EPCI CONTRACTOR FOR COMPANY APPROVAL.

LEGEND

- Pipeline Route
- - - HDD Trajectory

ABBREVIATIONS

LAT = Lower Astronomical Tide

REFERENCE DRAWINGS

DRAWING NUMBER	DESCRIPTION
IGI-1314-30-PL-DWG-002-001	SHORE APPROACH PROFILE - ITALY, HDD DRILLING PROFILE
IGI-1314-30-PL-DWG-002-002	SHORE APPROACH PROFILE - ITALY, HDD DRILLING WITH SOIL DATA
IGI-1314-30-PL-DWG-002-003	SHORE APPROACH PROFILE - ITALY, HDD ENTRY PIT

SCALE BAR

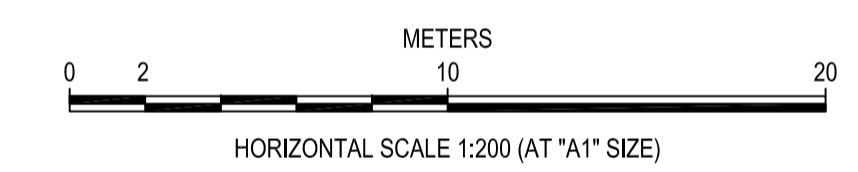

GEODETTIC & PROJECTION PARAMETERS

DATUM NAME	:	World Geodetic System 1984
REFERENCE SPHEROID	:	WGS84
Semi-major axis	:	6 378 137.000 m
Inverse flattening	:	298.257 223 563
PROJECTION	:	
Projection System	:	Universal Transverse Mercator (UTM)
Unit of coordinates	:	Meters
Latitude of origin	:	0° (Equator)
Central meridian (CM)	:	21° E (Zone 34 North)
False Easting at origin	:	500 000 m
False Northing at origin	:	0 m
Scale factor at CM	:	0.9996

REV	DATE	DESCRIPTION	DRWN	DSGN	ENGR	APPR	CLIENT
Y1	14 MAR 2019	APPROVED FOR USE	SM	WHH	WHH	MVV	
Y0	22 FEB 2019	ISSUED FOR CLIENT REVIEW	SM	WHH	WHH	MVV	
YA	04 FEB 2019	ISSUED FOR INTERNAL REVIEW	SM	JB	JB		

 WorleyParsons Group	PROJECT: IGI Poseidon Offshore Section Update
	CLIENT: IGI Poseidon
Project No.: 406010-00159 WBS Code: 1314 (FEED Deliverables) EDISON Doc. No.: DEPA Doc. No.:	

TITLE:

SHORE APPROACH PROFILE - ITALY

HDD EXIT PIT

DRAWN BY:	DATE:	CHECKED BY:	DATE:	APPROVED BY:	DATE:	SHEET:	004	OF	004
SM	22 JAN 2019	WHH	14 MAR 2019	MVV	14 MAR 2019				
SCALE AT 'A1' SIZE	PROJECT	CTR	AREA	DISCIPLINE	TYPE	NUMBER	REVISION		
1:200	IGI	1314	30	PL	DWG	002	Y1		